

Montageanleitung

Ⓒ mounting instruction Ⓕ Notice de montage Ⓖ Instrukcja montaży
Ⓔ Instrucciones de montaje Ⓘ Istruzioni di montaggio

ARKA...

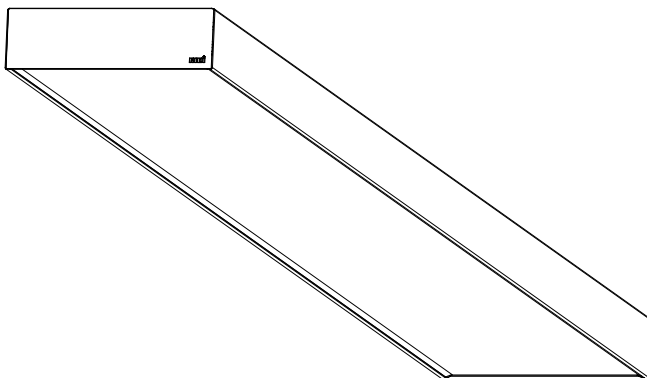

RIDI Leuchten GmbH
Hauptstrasse 31 - 33 · D-72417 Jungingen
Tel. 07477/872-0 · Fax 07477/872-48
kontakt@ridi-group.de · www.ridi-group.com



- (D) Für die Installation und für den Betrieb der Leuchten sind die nationalen Sicherheitsvorschriften zu beachten.
- (GB) Please note national safety instructions for installation and operation of this luminaire.
- (F) Pour l'installation et le fonctionnement des luminaires il est impératif de respecter les normes nationales de sécurité en vigueur.
- (PL) W celu prawidłowej instalacji i poprawnego działania oprawy należy przestrzegać krajowych przepisów bezpieczeństwa.
- (E) Para la instalación y la puesta en funcionamiento de las luminarias deben observarse las normas nacionales de seguridad.
- (I) Per l'installazione e il funzionamento delle lampade si fa riferimento alle normative di sicurezza nazionali.

- (D) Die Lichtquelle dieser Leuchte darf nur vom Hersteller oder einem von ihm beauftragten Servicetechniker oder einer vergleichbar qualifizierten Person ersetzt werden.
- (GB) Only the manufacturer, a trained service technician or another equally qualified person is permitted to replace the light source of this luminaire.
- (F) La source lumineuse de ce luminaire ne peut être remplacée que par le fabricant, un technicien de service mandaté par celui-ci ou une personne présentant une qualification analogue.
- (PL) Wymiany źródła światła w tej oprawie oświetleniowej może dokonać wyłącznie producent bądź uprawniony pracownik serwisu albo osoba o podobnych kwalifikacjach.
- (E) La fuente de luz de esta luminaria solamente podrá ser sustituida por el fabricante o una persona designada por este, ya sea un técnico de servicio u otra persona debidamente cualificada.
- (I) La sorgente luminosa di tale lampada può essere sostituita solo dal produttore o da un tecnico di assistenza da questi designato oppure da personale dotato di qualifica equivalente.



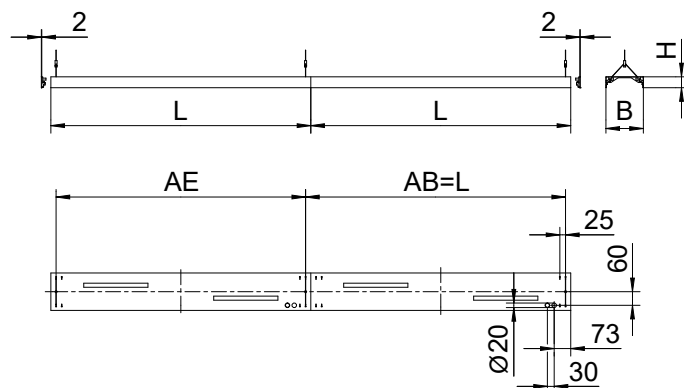
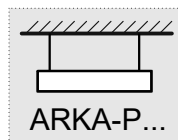
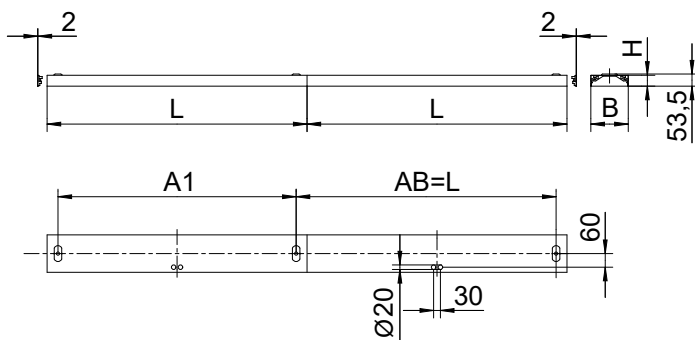
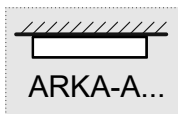

Type	L	B	H	A1	AB	AE	
ARKA-A1135...	1131	167	48	950	1131	-	220
ARKA-P1135...	1131	167	48	-	1131	1085	280
ARKA-A1415...	1411	167	48	1230	1411	-	270
ARKA-P1415...	1411	167	48	-	1411	1365	330

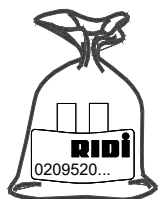
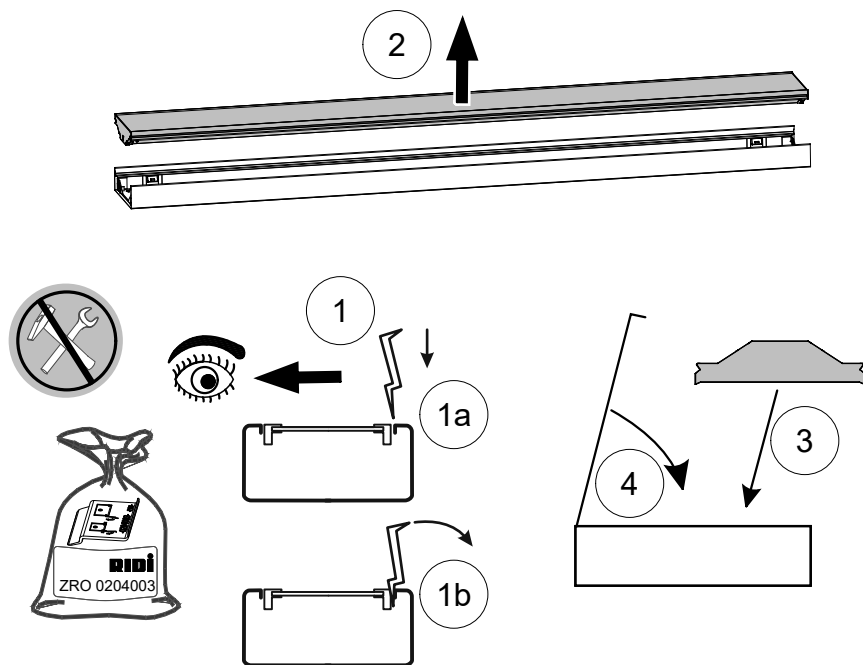

ARKA-ED...

ARKA...

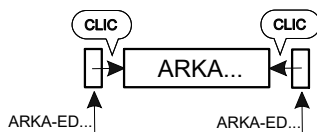

ARKA... ARKA...

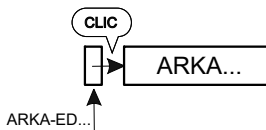

ARKA... ARKA...

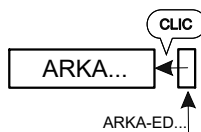

ARKA... ARKA...

ARKA...

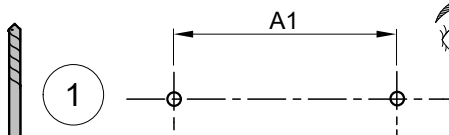
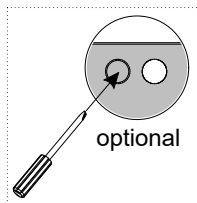
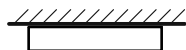

3/11

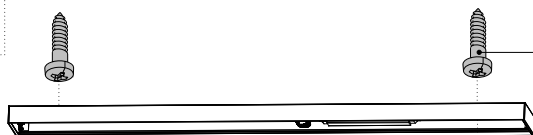

bauseits
to be supplied on-site
À prévoir sur place
we własnym zakresie
por parte del cliente
a cura del cliente

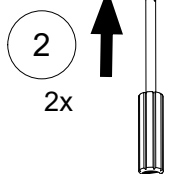
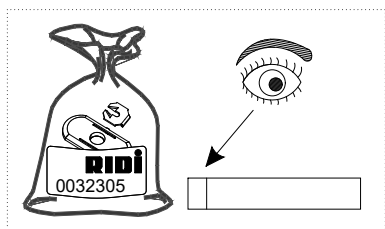

3/11

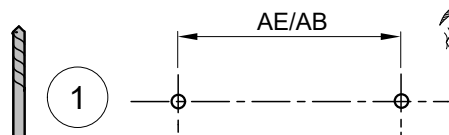
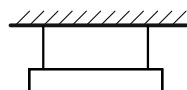

3/11



0008286

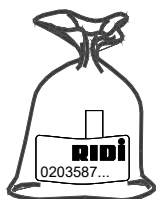

bauseits
to be supplied on-site
À prévoir sur place
we własnym zakresie
por parte del cliente
a cura del cliente



3/11

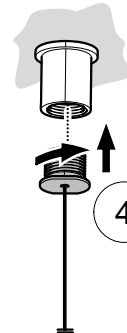
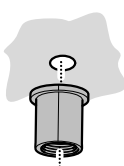



??V / ??Hz



RIDI
.....V
.....Hz

ND

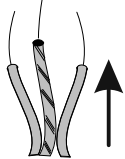
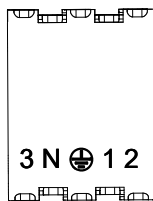

DALI

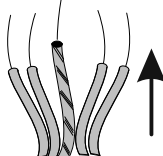
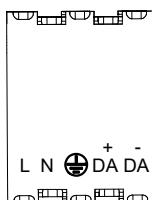

	mm	A
	0,5-1,0	9
sol.	1,5-2,5	12
0,5-2,5 mm ²		

	Ø	A
	0,8-1,2	9
	1,3-1,8	12
max Ø1,8mm		

	Ø	A
	0,8-1,2	9
	1,3-1,8	12
max Ø1,8mm		

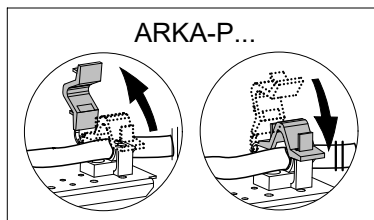
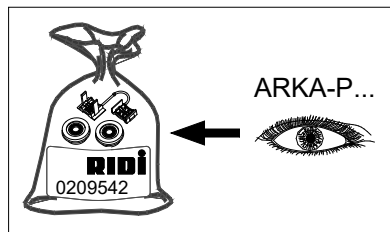

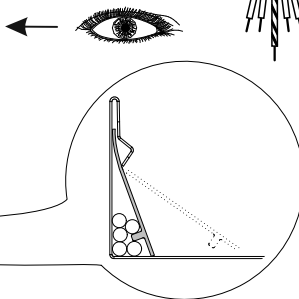
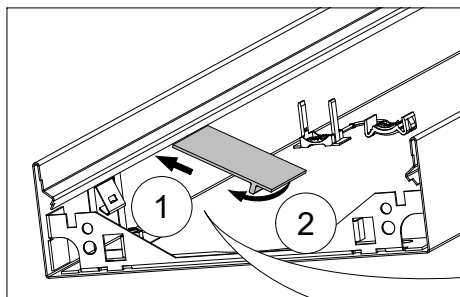
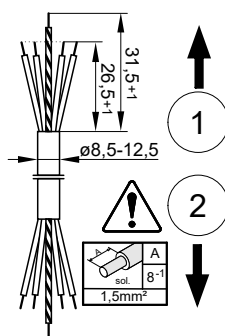
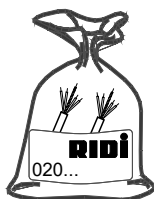

0209536	ZIDV-ARKA 1135/5/1,5
0209537	ZIDV-ARKA 1415/5/1,5

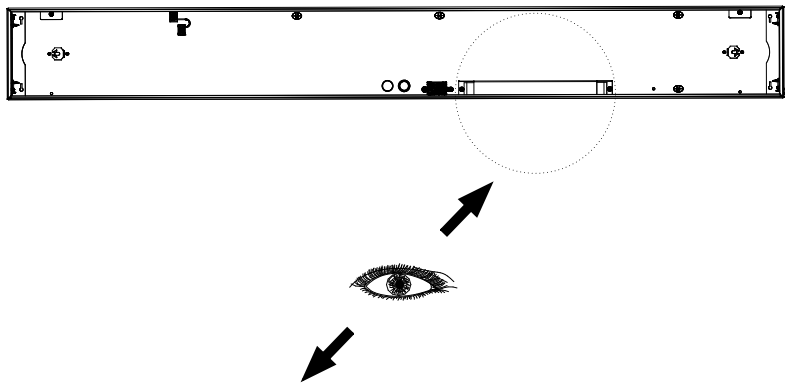

ARKA-...FL...



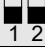

ARKA-A...FL...

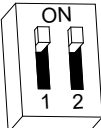
Pos	I (mA)
 1 2	200
 1 2	250
 1 2	300
 1 2	350

 ON 1 2

*

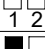
ARKA-P...FL...

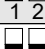
Pos	I (mA)
 1 2	200
 1 2	250
 1 2	300
 1 2	350

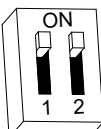
 ON 1 2

*

- *
- (D) Werkseinstellung
 - (F) Réglage d'usine
 - (E) Ajuste de fábrica
 - (GB) Factory setting
 - (PL) Ustawienie fabryczne
 - (I) Impostazione predefinita

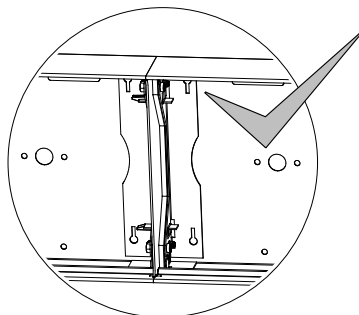
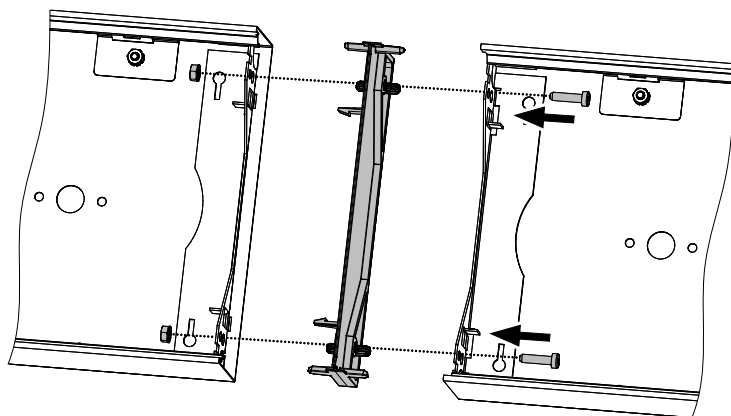
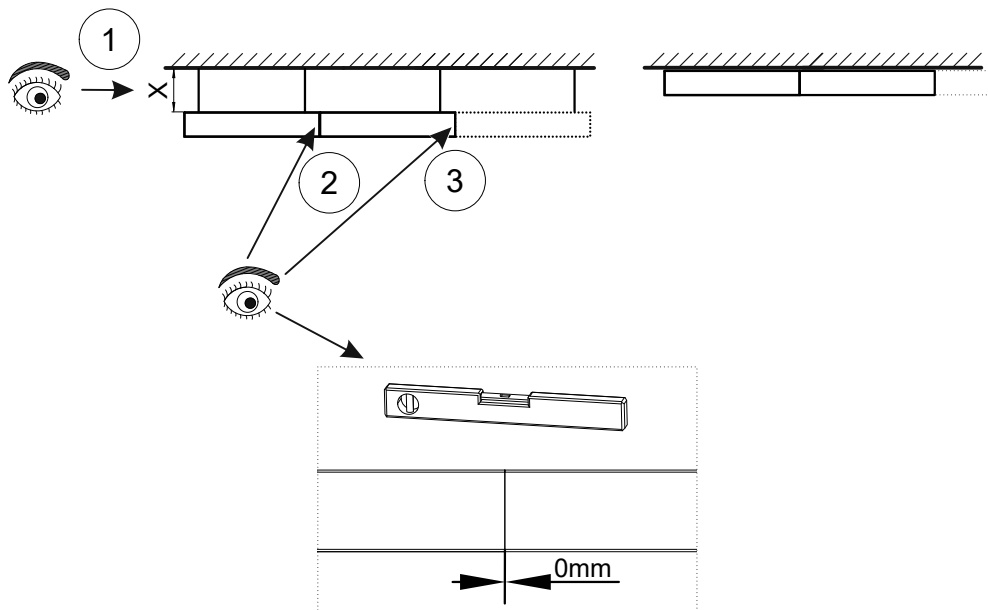

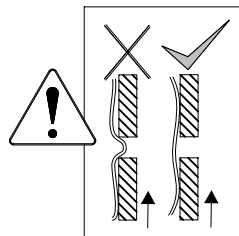
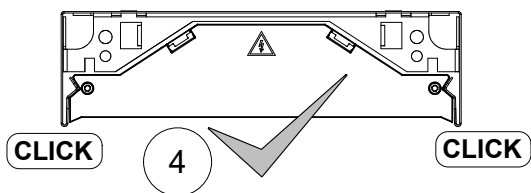
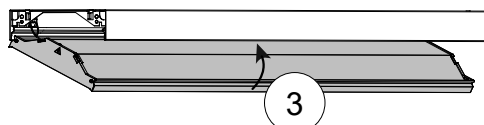
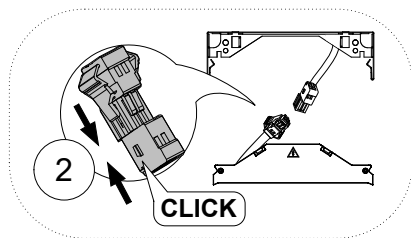
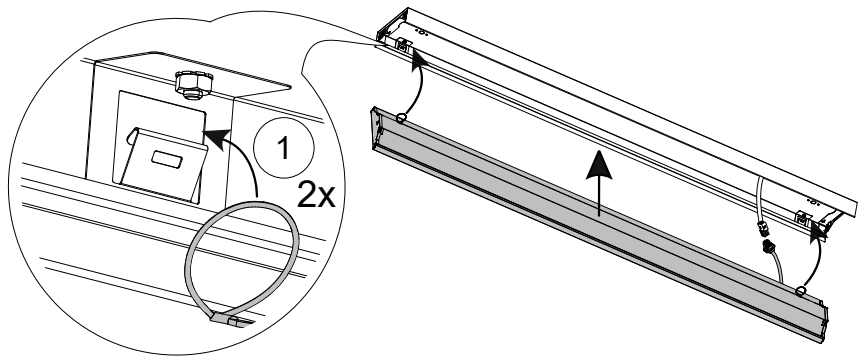
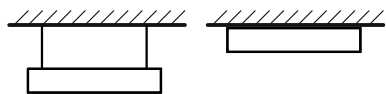

Demontage / Removal
Démontage / Demontaz
Desmontaje / Smontaggio

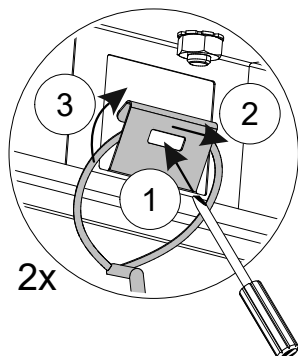

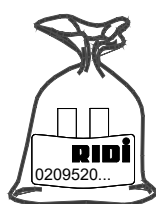
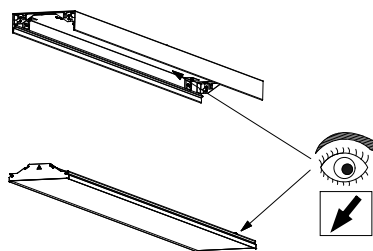
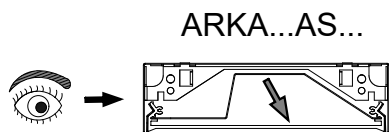

ARKA-ED...

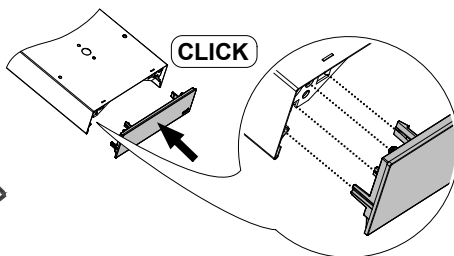

ARKA...SEN

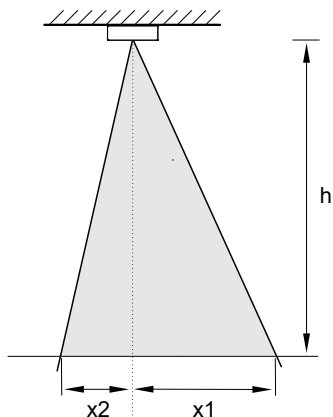

h	x1	x2	y	d
1,7 m	1,3 m	0,7 m	1,0 m	3,0 m
2,0 m	1,6 m	0,8 m	1,2 m	3,6 m
2,3 m	1,8 m	0,9 m	1,3 m	4,1 m
2,5 m	2,0 m	1,0 m	1,4 m	4,5 m
2,7 m	2,1 m	1,1 m	1,6 m	4,9 m
3,0 m	2,3 m	1,2 m	1,7 m	5,4 m
3,5 m	2,7 m	1,4 m	2,0 m	6,3 m
4,0 m	3,1 m	1,6 m	2,3 m	7,2 m

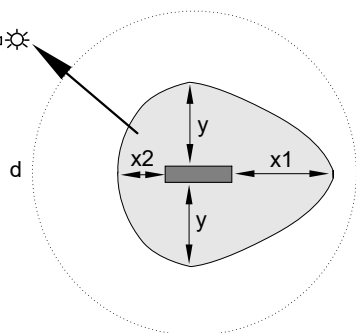

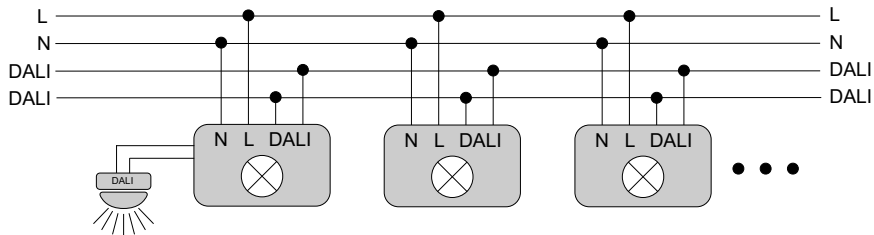

Informationen zur Inbetriebnahme

- Ⓒ Commissioning information Ⓕ Informations sur la mise en service Ⓖ Informacje o uruchomieniu
Ⓔ Información para la puesta en servicio Ⓘ Informazioni sulla messa in servizio

